



# **Child Seat with 5-Point Harness**

User Manual

# Table of Contents

1. About This Manual.....	01
2. Product Description .....	02
3. Safety Notices.....	03
4. Specifications.....	03
5. In the Box .....	04
6. Installation Instructions .....	05
7. Usage Guide.....	12
8. Care and Maintenance .....	15
9. Warranty .....	16

# 1. About This Manual

---

This manual contains important information about the installation, use, and maintenance of your TARRAN Child Seat. Please read it carefully before use and keep it for future reference. The instructions and warnings in this manual help ensure safety and prevent damage to the product.

## 2. Product Description

---



The TARRAN Child Seat is designed specifically for T1 Pro cargo bike to provide a safe, comfortable seating solution for children. The seat features a durable aluminum frame, water-resistant cushioning, and a 5-point safety harness system to keep your child secure during rides. When not in use, the seat can be folded down to maximize cargo space in your T1 Pro.

## 3. Safety Notices

---

### Warning!

- Children must always be secured with the 5-point harness and wear appropriate bicycle helmets.
- Do not use for children outside the specified range: under 9 months OR over 7 years / 126 cm / 50 kg.
- Ensure the Child Seat is properly installed and attached before each ride.
- Be mindful of pinch points and gaps in the Child Seat, particularly when folding or unfolding. Keep children's fingers clear to prevent injuries.
- Never leave children unattended in the seat, even when stationary.
- Ensure children's bodies, clothing, and toys do not contact moving bike parts.
- Do not exceed the cargo box's maximum load (65 kg) when using Child Seat(s).
- Remove the Child Seat when transporting the bike on a vehicle.

## 4. Specifications

---

- Materials: Aluminum frame, water-repellent polyester, quick-release cotton pad
- Dimensions (Unfolded): 560 mm × 365 mm × 475 mm
- Dimensions (Folded): 560 mm × 200 mm × 475 mm
- Total weight: 4.8 kg
- Gross weight: 4.4 kg
- Maximum child weight: 50 kg
- Maximum child height: 126 cm
- Storage pocket capacity: 2 kg
- Compatible with: TARRAN T1 Pro

## 5. In the Box

---



- 1× Child Seat
- 1× Tool Set, including:
  - 2× Long bolts (for front installation)
  - 2× Short bolts (for rear installation)
  - 6× Washers
  - 1× Seat notch
  - 4× Seatbelt pads
  - 1× Allen wrench
  - 1× Wrench

# 6. Installation Instructions

---

## 6.1 Required Tools

- Allen wrench (included)
- Wrench (included)

## 6.2 Preparation

For optimal child safety, the Safety Collar should be installed on your T1 Pro before installing the Child Seat. If the Safety Collar is not yet installed, please refer to its user manual before proceeding.

## 6.3 Installation Steps

1. Determine the installation position

This manual illustrates the rear installation position, which uses the short bolts. For front installation, use the long bolts.

2. Attach the mounting hardware

- o Place washers on the bolts.
- o Insert the bolts into the reserved threaded holes on the rim of the cargo box.
- o Hand-tighten initially, then secure with the wrench to 15 Nm.

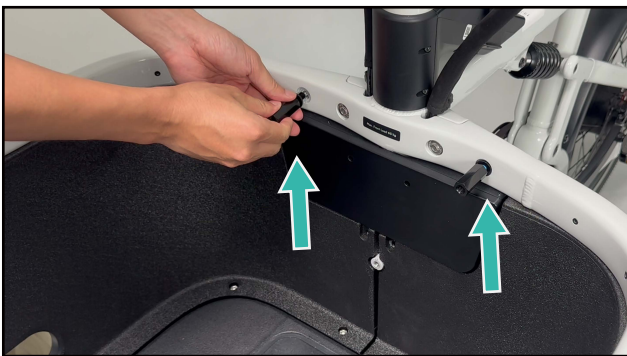

### 3. Install the seat notch

- Attach the long screw to the notch.
- Position the notch so the ledge aligns with the gap in the cargo box (perpendicular to the box as shown in the image).
- Tighten with the allen wrench to 15 Nm.

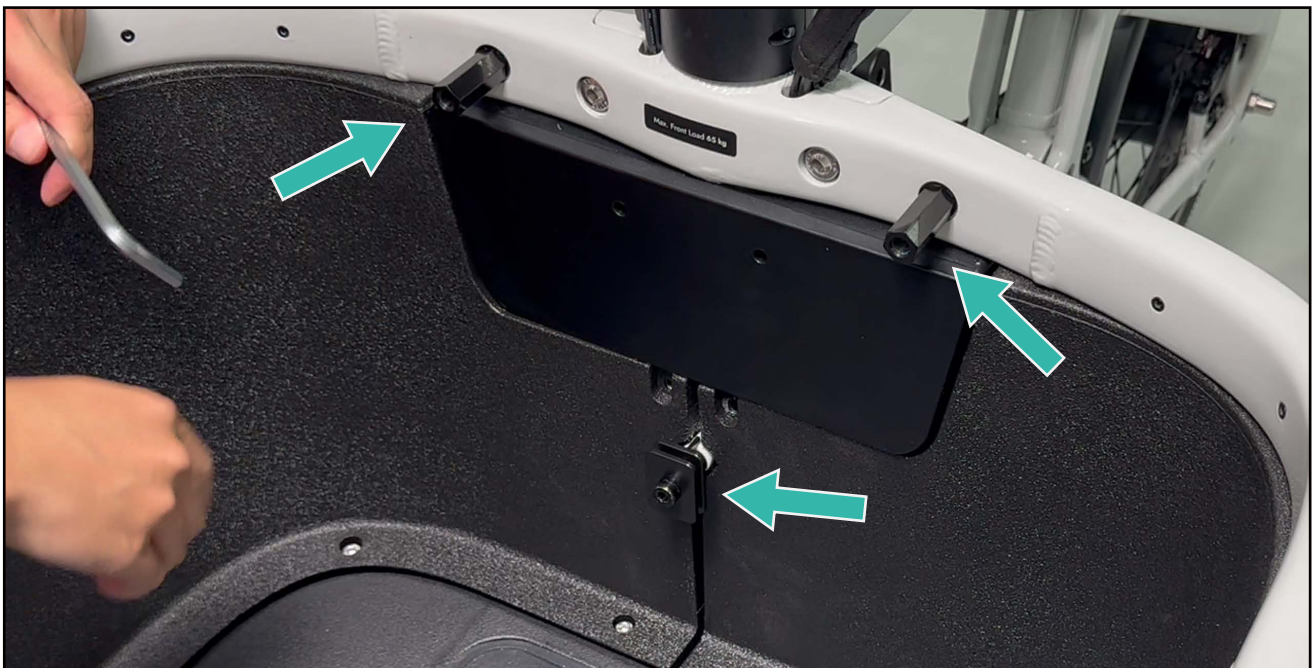

 Follow the same steps to attach the long bolts and notch to the front of the cargo box.

---

#### 4. Attach the Child Seat

- Position the Child Seat onto the notch.

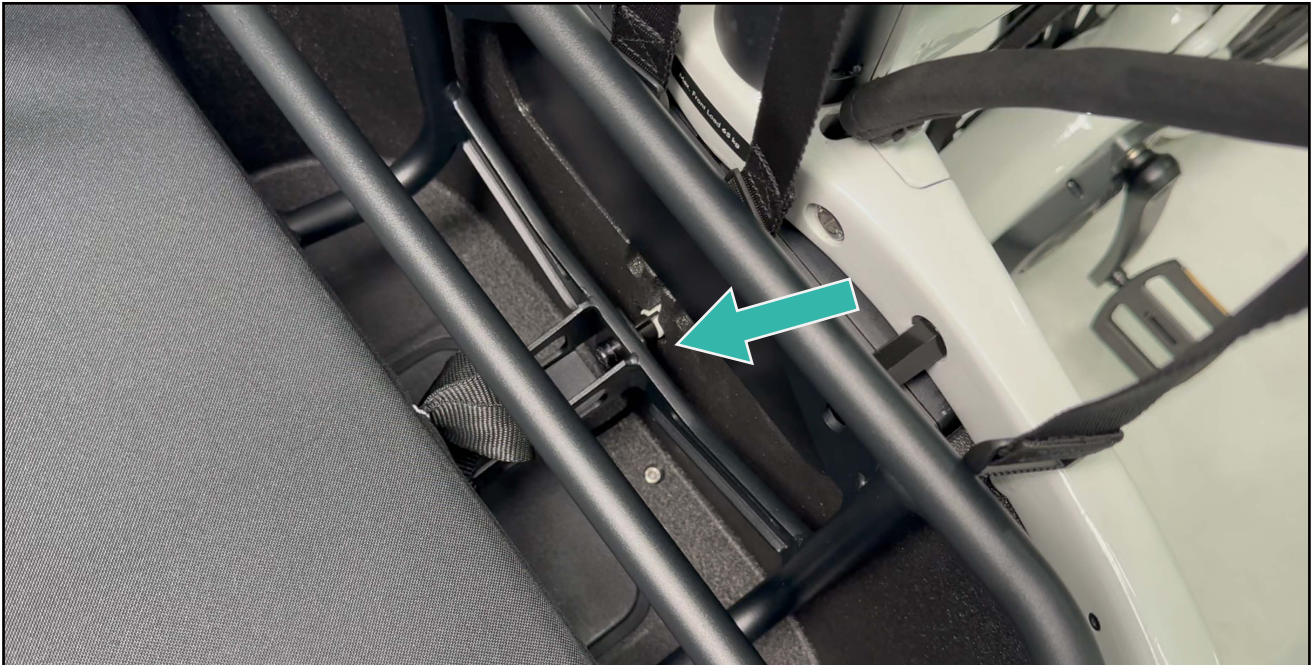

- When properly notched, pull the seat down so the top edge rests just beneath the Safety Collar's edge.



- Without Safety Collar: Ensure the seat is properly seated in the bottom notch. This is essential for the side screws to align and secure correctly. If the seat isn't positioned properly, the top screws cannot be tightened.

---

5. Secure the seat frame

- Attach washers to the 2 short screws.



- Pull the seat padding down to expose the frame.



- Align the frame mounting holes with the threaded holes in the cargo box.
- Pull the seat padding down to expose the frame.

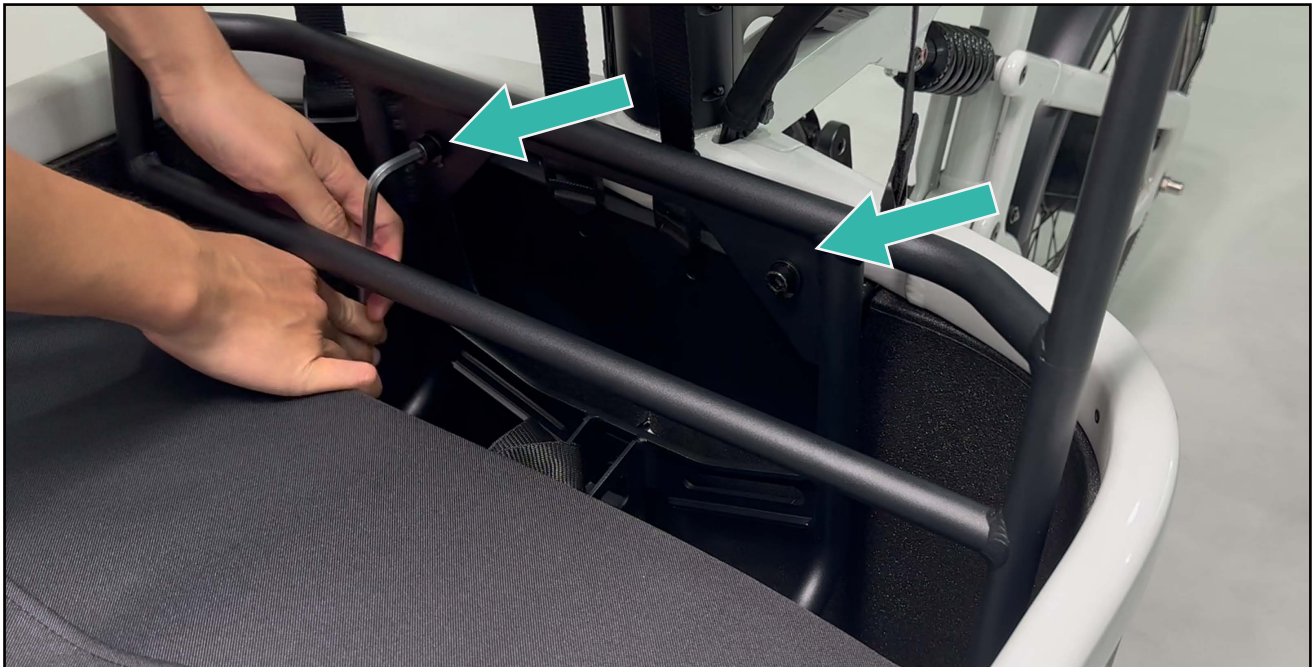

- Tighten with the allen wrench to 15 Nm.

#### 6. Prepare the harness system

- Thread the 4 seat straps through the designated openings in the seat pad cover.



- Pull the straps tight so they rest correctly against the back of the seat pad.

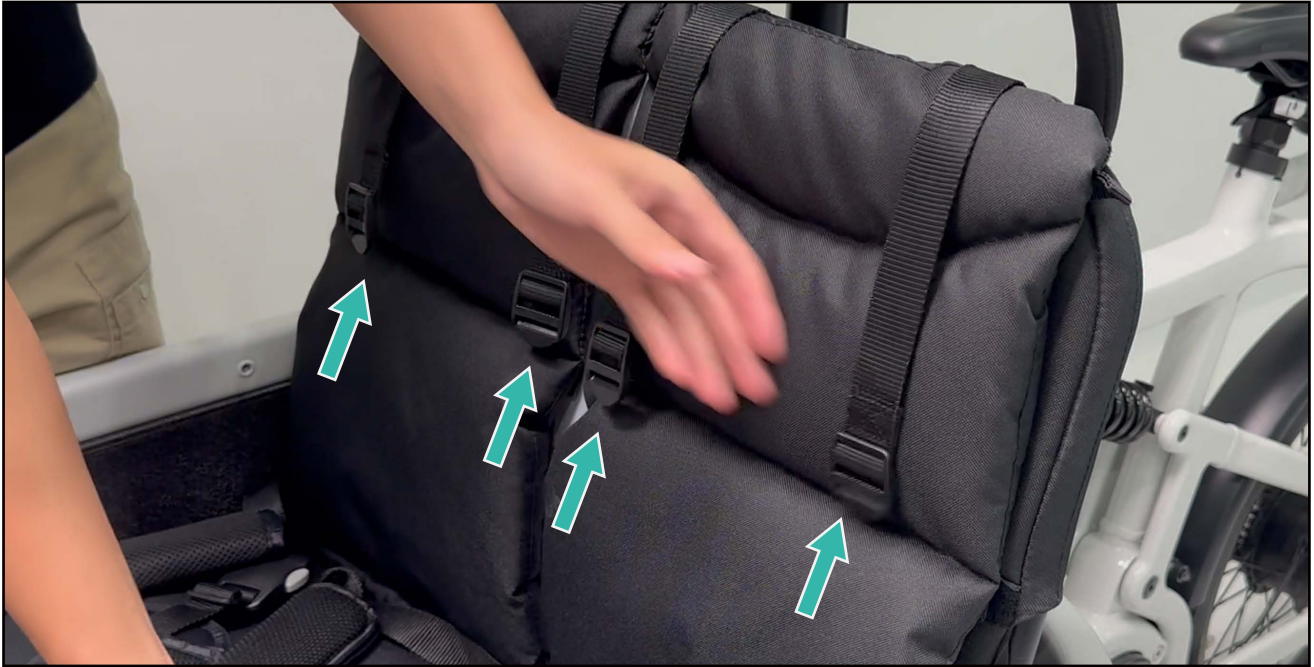

- Attach the seatbelt pads to the shoulder straps. Position the pads with their seams facing outward, away from the child's skin, to prevent discomfort and chafing.



- 
- Thread the bottom seat strap through the seat buckle.



#### 7. Verify installation

- Check that all mounting hardware is securely tightened.
- Ensure the seat does not move or shift when pressure is applied.
- Confirm that the harness system operates correctly.

# 7. Usage Guide

---

## 7.1 Securing a Child in the Seat

1. Unfold the Child Seat if it's in the folded position.



**Note:** ONLY adults should perform the unfolding operation to prevent pinching injuries to children.

2. Open the 5-point harness by pressing the center button on the buckle.
3. Place the child in the seat, ensuring their back is fully against the seat back.
4. Bring the shoulder straps over the child's shoulders.
5. Connect the left and right upper harness clips together.
6. Insert the connected upper clips into the bottom buckle until you hear a click.



7. Adjust all straps for a snug but comfortable fit. You should be able to fit two fingers between the strap and the child's body.
8. Position the seatbelt pads for comfort.

---

## 7.2 Adjusting the Harness Height

The shoulder straps can be adjusted to different heights to accommodate your growing child:

1. From the rear of the seat, locate the harness connectors.
2. Detach the connectors from their current position.
3. Thread them through the desired height slots.
4. Ensure both shoulder straps are at the same height and the straps are not twisted.

## 7.3 Storage Features

- A mesh storage pocket is located under the seat for small items (maximum load: 2 kg).
- Avoid storing sharp objects that could damage the fabric.



---

## 7.4 Folding the Seat When Not in Use

When not carrying children, you can fold the Child Seat to maximize cargo space:

1. Unbuckle the harness system.
2. Fold the seat back forward.
3. Secure it in the folded position using the integrated retention strap.

## 7.5 Removing the Child Seat

To remove the Child Seat from the cargo box:

1. Detach the harness straps by pulling on the finger loops located on either side of the seat back.



2. Lift the seat pad up and out.
3. Loosen and remove the mounting screws from the seat frame.
4. Lift the seat up and away from the notch.
5. Store the Child Seat and hardware in a safe, dry place. Or keep it in the cargo box by laying it flat.

# 8. Care and Maintenance

---

## 8.1 Regular Checks

Before each use, check:

- All mounting hardware for tightness
- The harness system for damage or wear
- The buckle for proper function
- The seat padding for damage

## 8.2 Cleaning

- The seat pad covers are removable and machine washable.  
Follow these steps to remove:
  1. Detach the seat pad by pulling it away from the velcro attachments on the frame.
  2. Wash at 30°C on a gentle cycle with mild detergent.
  3. Air dry completely before reinstalling.
- The frame and plastic components can be cleaned with a damp cloth and mild soap.
- Do not use abrasive cleaners, solvents, or pressure washers.



---

## 8.3 Storage

- Store the Child Seat in a dry place when not in use.
- Avoid prolonged exposure to direct sunlight, extreme temperatures, or high humidity.
- If storing the bike outdoors, consider removing the Child Seat or covering it.

## 9. Warranty

---

TARRAN provides a limited warranty for the Child Seat with 5-Point Harness. For complete warranty information, terms, and conditions, please visit our warranty policy page at:

<https://tarranbikes.com/pages/warranty-policy>

The warranty covers manufacturing defects in materials and workmanship under normal use. It does not cover damage from misuse, accidents, improper installation, or normal wear and tear.

For more information or if you have questions, please contact your authorized TARRAN dealer or visit

[www.tarranbikes.com](http://www.tarranbikes.com).